

EXISTING

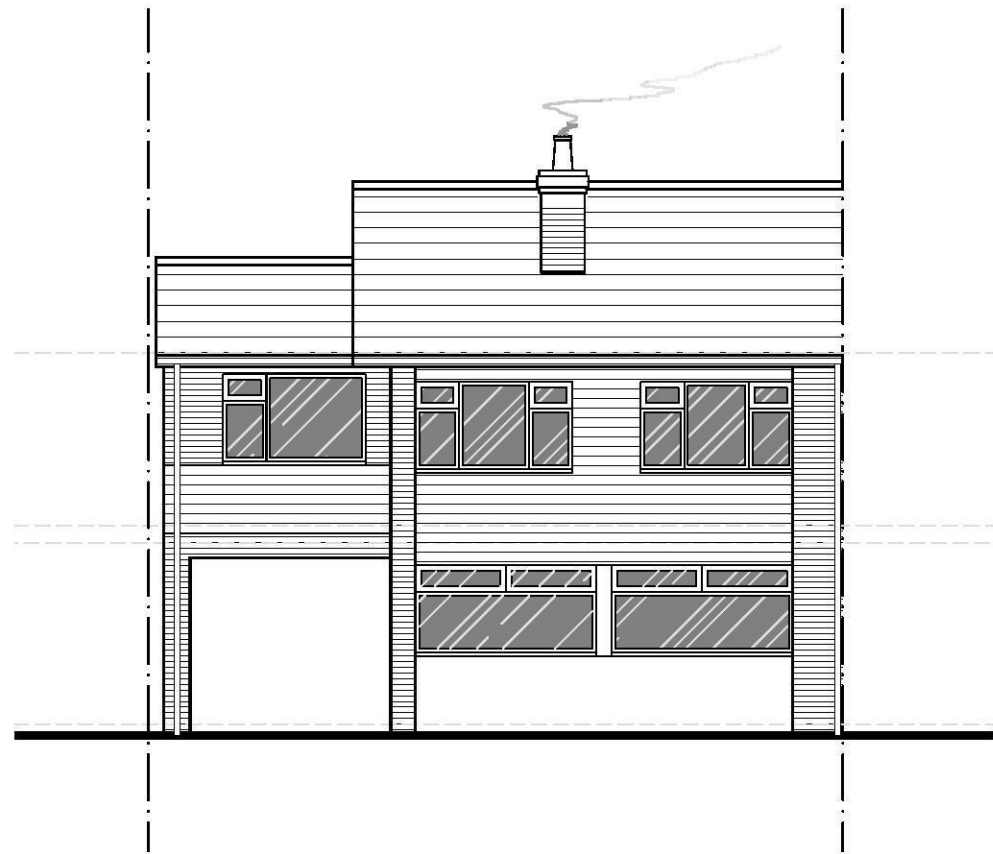

FRONT

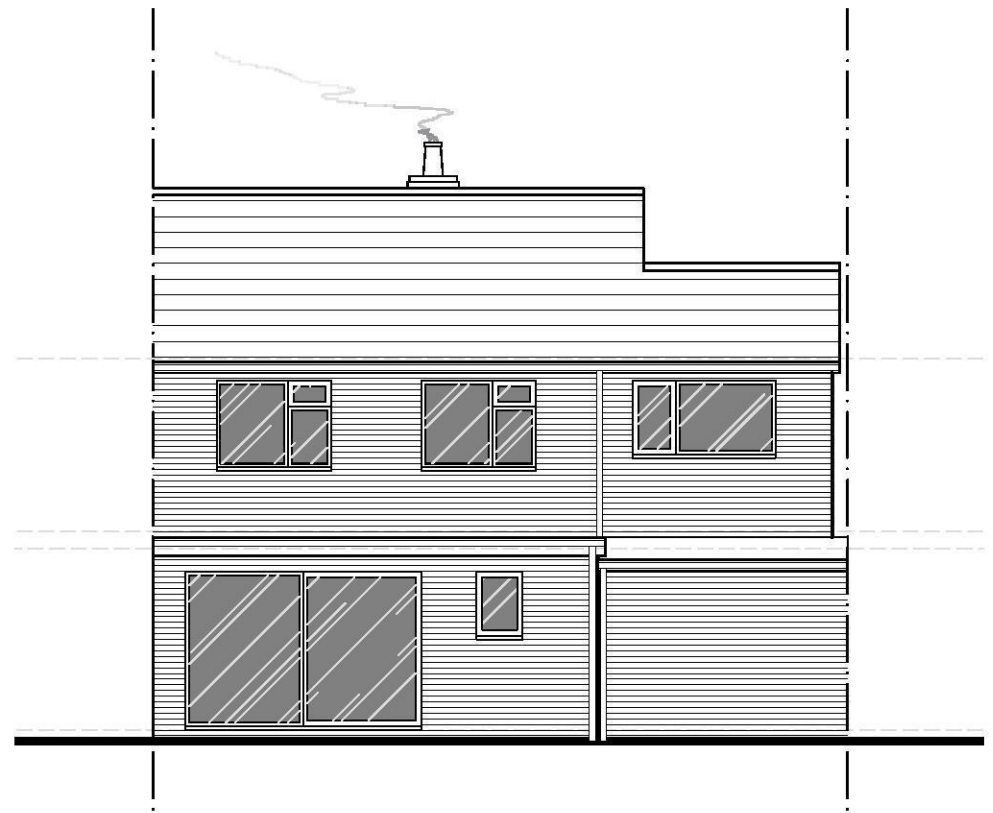

REAR

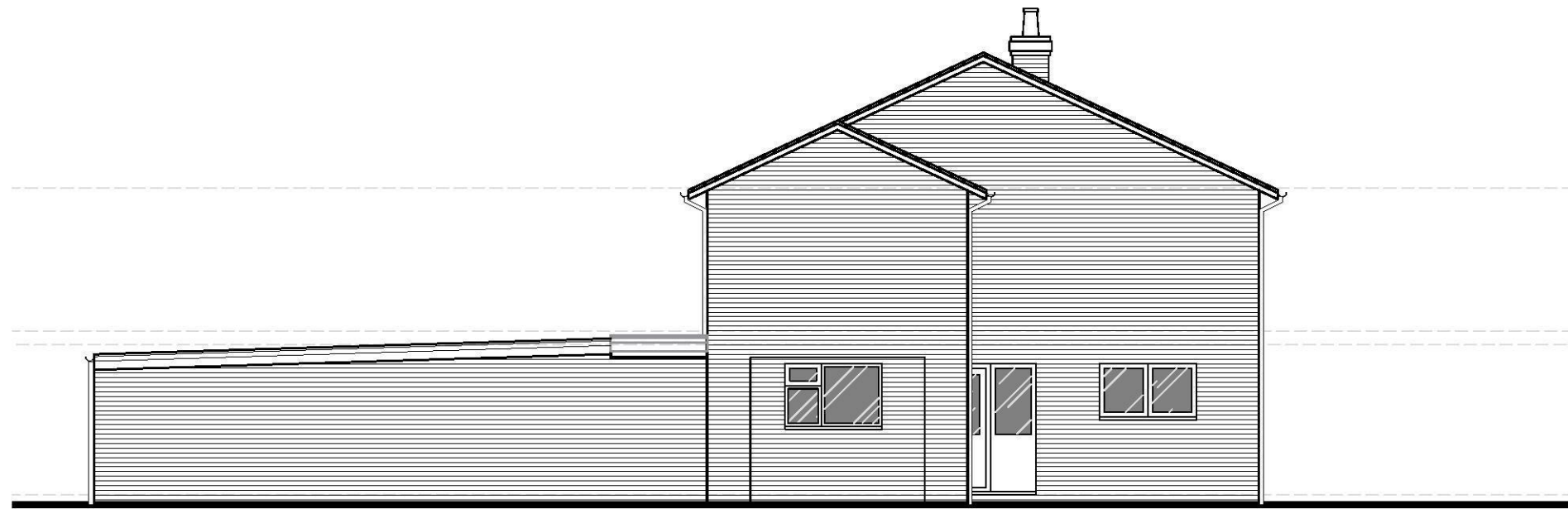

SIDE

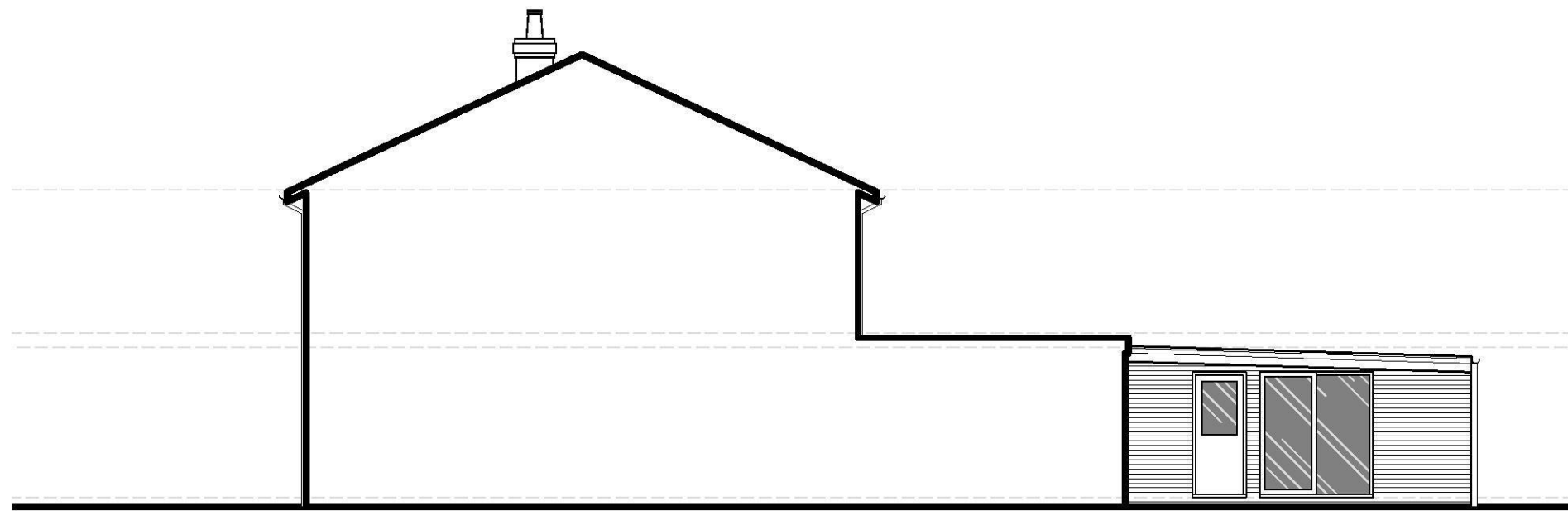

SIDE / SECTION

Scale @ 1:100
5m 4m 3m 2m 1m 0m

PROPOSED

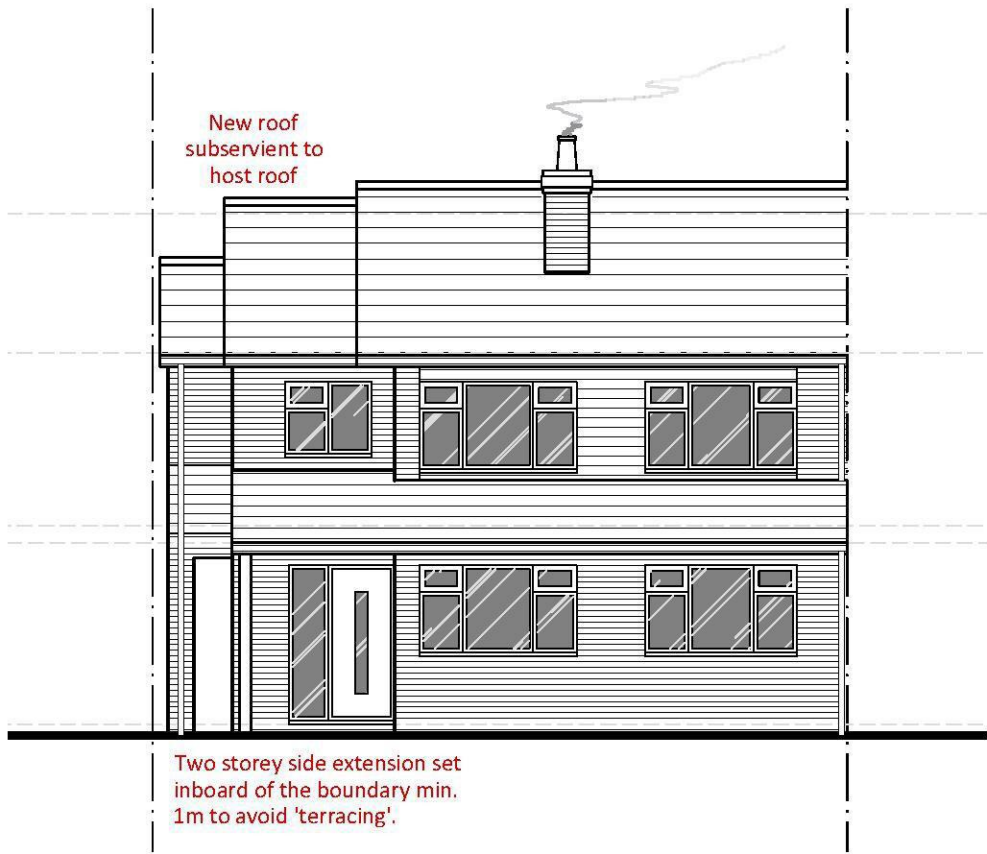

Two storey side extension set inboard of the boundary min. 1m to avoid 'terracing'.

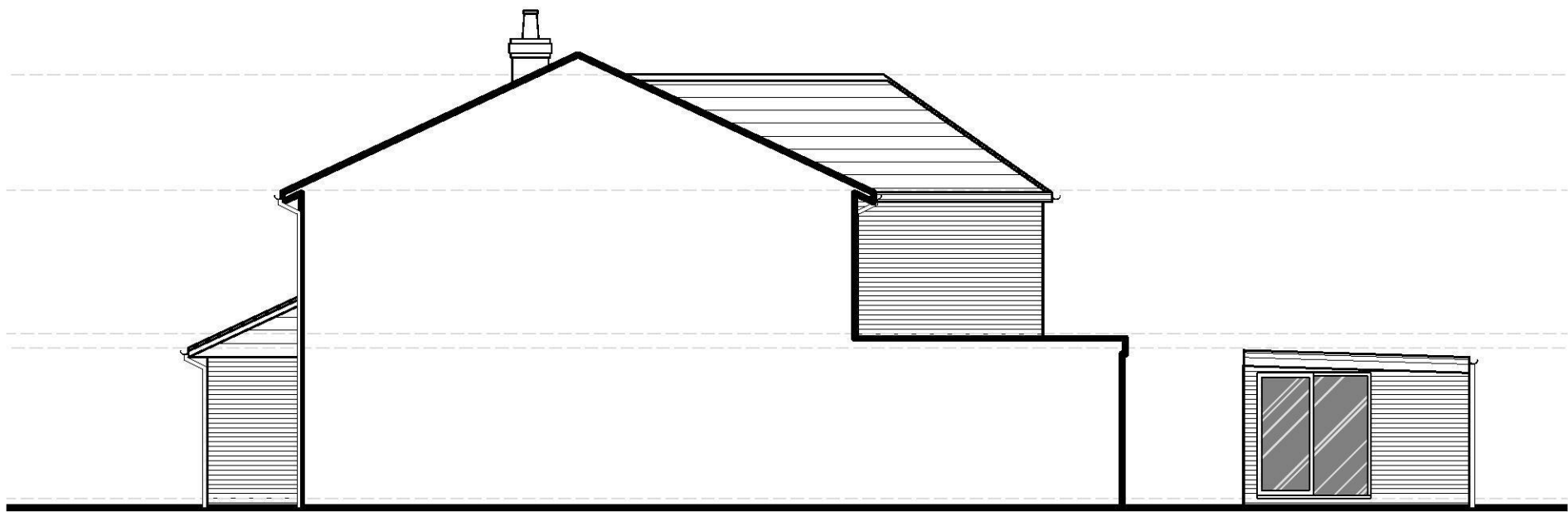
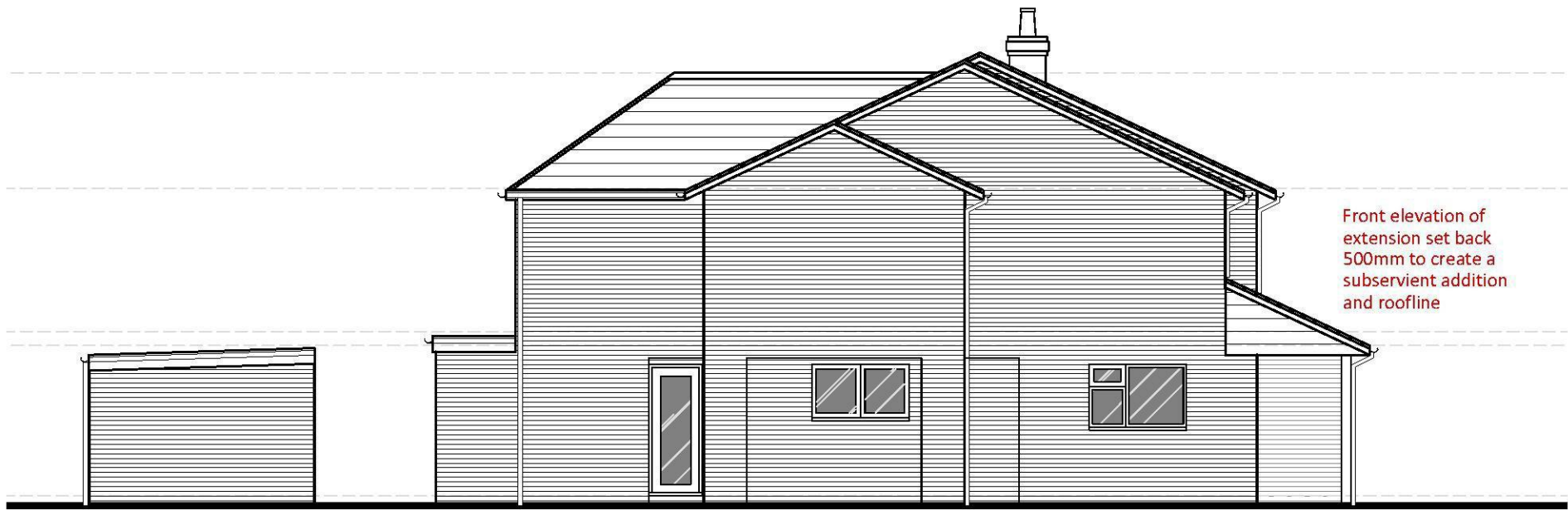
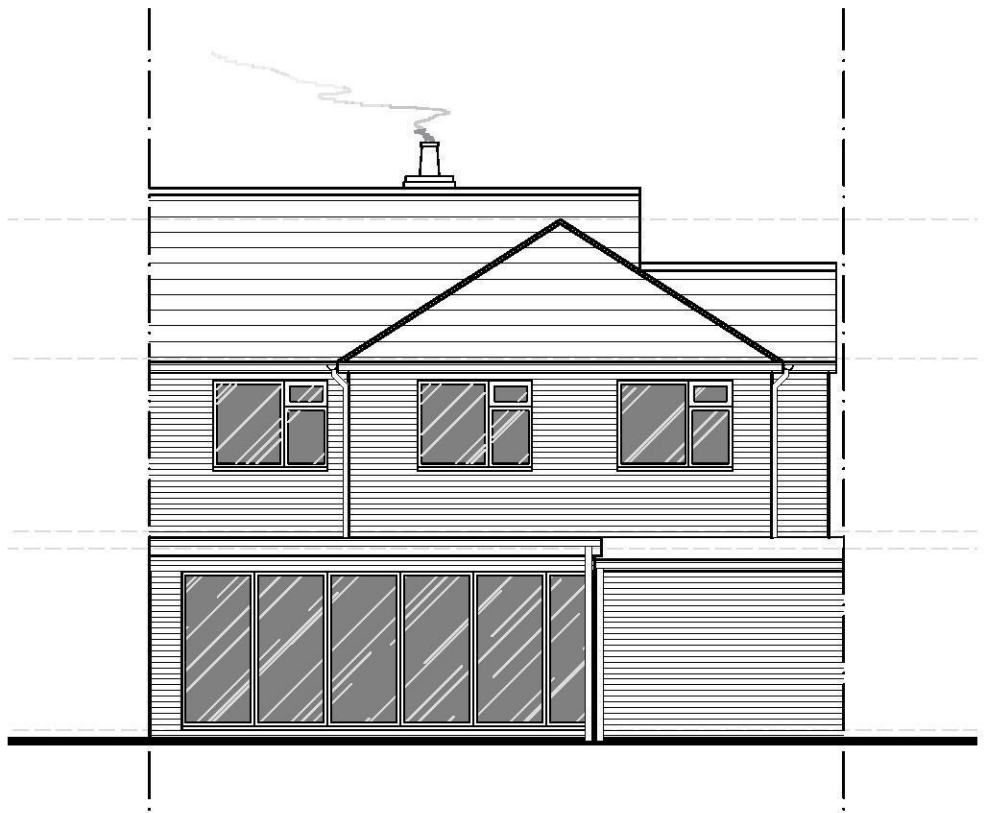

SIDE / SECTION

Scale @ 1:100
5m 4m 3m 2m 1m 0m

GENERAL NOTES

This scheme is subject to Town Planning and all other necessary consents. Dimensions, areas and levels where given are only approximate and subject to site survey. All dimensions are to be checked on site. All feasibility studies are subject to full site survey. This drawing is to be read in conjunction with all relevant consultants and/or specialists drawing/documents and any discrepancies or variations are to be notified to the architects in writing before the affected work commences. All queries relating to design of structural elements are to be referred to the structural engineering consultant for resolution. The workmanship and materials of all trades and building operations shall comply with the recommendations of British Standard (BS)8000 parts 1-16 inclusive and with Approved Document to support Regulation 7 1999 edition (incorporating 2000 amendments) of the Building Regulations 2010. All design and construction is to be in accordance with the Construction (Design and Management) Regulations 2007.

Rev	Date	Description
-----	------	-------------

R J B
Architect

RJB Architect
146 Main Road
Danbury
Essex
CM3 4DT

T 07979 570036 W www.RJBarchitect.com E richard@RJBarchitect.com

PLANNING

arb
Architects Registration Board

Client
Jaimie Goodman

Project
21 The Spinneys
Hockley
Essex

Drawing Title
Existing & Proposed Elevations

Drawn	Date	Checked	Scale @ A1
RJB	Nov 2020		As noted
Job No	Drawing No	Revision	Note
2020-74	03		