

Contractors must check all dimensions on site. Only figured dimensions are to be worked from. Discrepancies must be reported to Telebeam prior to works commencing on site.

The document and data it records are confidential and for the use of authorized persons only exempt with Telebeam prior written consent. THIS DRAWING IS COPYRIGHT ©

It must not be copied in whole or part in any form, used for any purpose or disclosed to any person and all rights (including Copyright and Design rights) therein belong to Telebeam Ltd ©

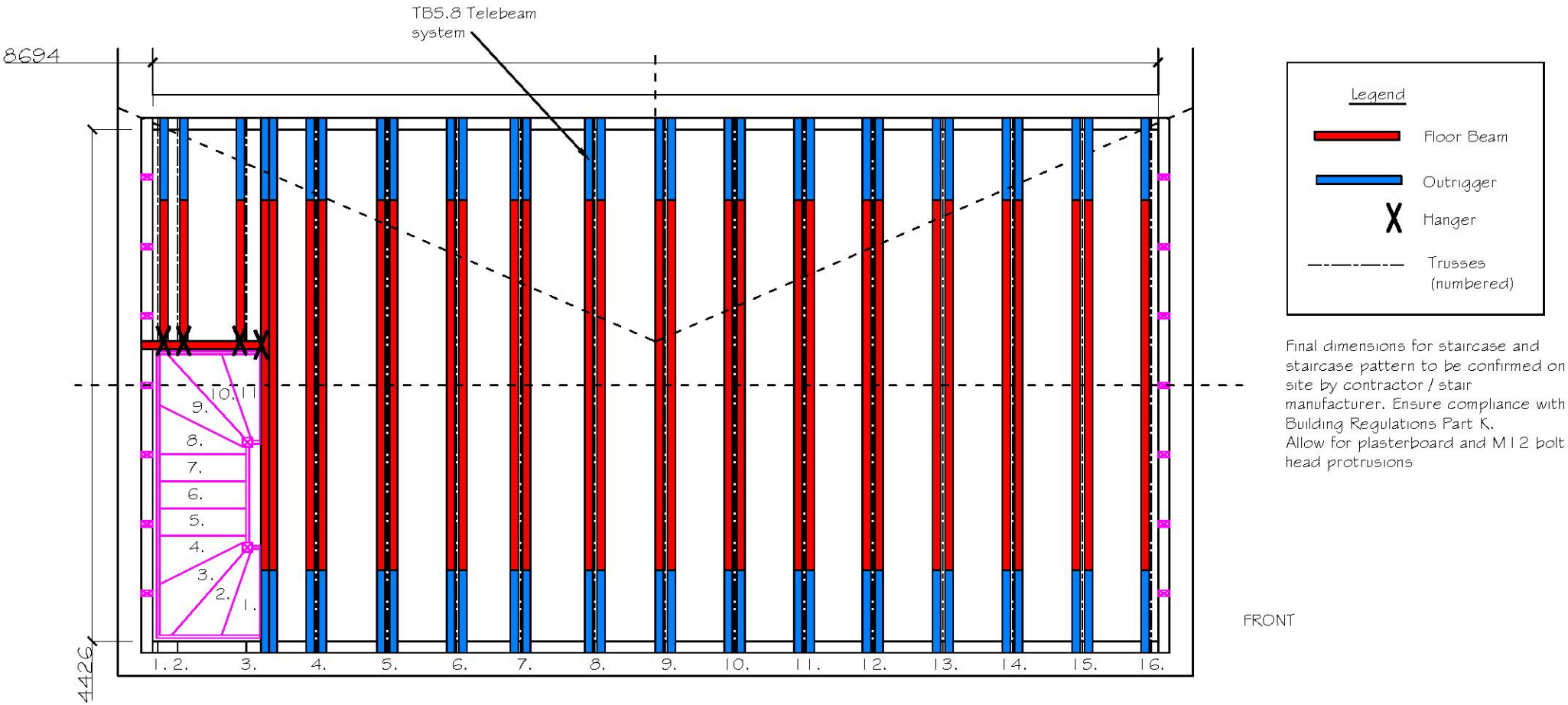

<div><div>TeleBeam™</div><div>the unique loft conversion &amp; flooring system</div></div> <div>Unit 6 Devizes Trade Centre Hopton Park Devizes Wiltshire SN10 2EH</div> <div>Tel: 01380 739000 Website: <a href="http://www.telebeam.co.uk">www.telebeam.co.uk</a> Email: <a href="mailto:info@telebeam.co.uk">info@telebeam.co.uk</a></div>		
Title Proposed Loft Conversion At 1 Highwell Gardens, Hockley SS5 4LY		
Client Mr N Waters		
Detail Telebeam Layout		
Drawing no. 04	Revision A	
Reference TB23243	Scale 1:50@A3	
Date May 2023	Drawn by ACR	Checked by SBR