

Public Holiday

**From:** Mollie Fielden  
**Sent:** 15 February 2019 09:09  
**To:** Data Scanning  
**Subject:** FW: REF: 19/00033/DPDP1

**From:** Paul Cane  
**Sent:** 28 January 2019 10:44  
**To:** [planning.applications@rochford.gov.uk](mailto:planning.applications@rochford.gov.uk)  
**Cc:** Paul Cane [paucane27@aol.com](mailto:paucane27@aol.com)  
**Subject:** REF: 19/00033/DPDP1

Aviva Investors: **Public**

FAO Ms Katie Ellis Re. 19/00033/DPDP1

I've been made aware of the above planning application, usually for the applications associated to 14 Main Road Hawkwell we receive postal notification, on this occasion we do not appear to. Firstly can that be checked? My address is 9 Nursery Drive (SS54FH), which backs on to the property in question. We received the last application in in Q4 last year, which I note has now been rejected and replaced by the above?

I believe for the first time this new application is the first which impacts directly on our property as the proposed 5.8m extension will extend across the back of our property and the window in what I assume is a bathroom within the Living Room, will overlook our garden. Per below image.

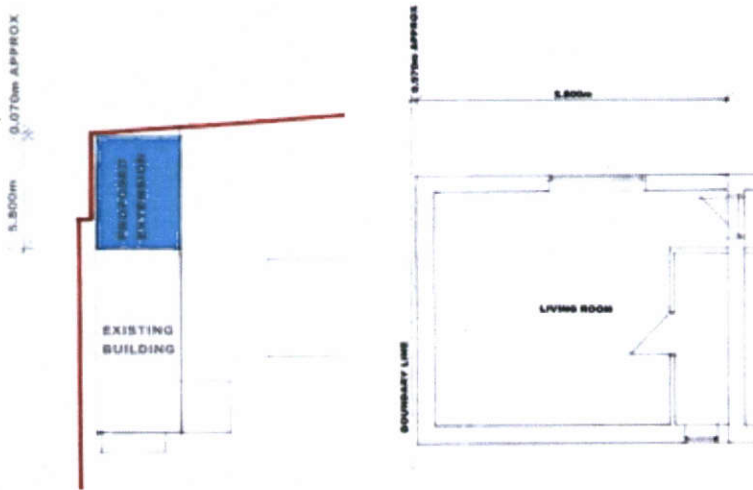

Please can you confirm via the land registry the ownership of the various fences across our boundaries as I note the extension will follow a boundary? I ask because I believe there's a small strip of no-mans land which runs between our properties. Currently there are 2 8ft fence panels on the applicants side, between the strip and our boundary fence.

Also please can you confirm regarding future approvals, once the properties foot print has been extended how long could it be before the applicant could request approval for a second story extension on the new foot print. Per previous rejections I believe one of the other neighbours has raised this on several occasions.

Based on the above responses I'll be able to submit a formal response.

Thanks in advance Katie.

Regards,

Paul Cane

This message has been classified **Public** on 28 January 2019 at 10:43:42.

This email transmission and any attachments may contain confidential or legally privileged information that is intended for the addressee(s) only. Any views or opinions presented are solely those of the author and do not necessarily represent those of Aviva Investors. If you are not the intended recipient or person responsible for delivering this information to the intended recipient you are hereby notified that any disclosure, copying, distribution or reliance upon the contents of this email is strictly prohibited. If you have received this email transmission in error please notify the sender immediately so that we may arrange for its proper delivery and delete the message from your inbox.

Aviva Investors Global Services Limited, registered in England No. 1151805. Entered on the Financial Services Register, No: 119178. Authorised and regulated by the Financial Conduct Authority.

Aviva Investors Pensions Limited, registered in England No. 1059606. Entered on the Financial Services Register, No: 110410. Authorised by the Prudential Regulation Authority and regulated by the Financial Conduct Authority and the Prudential Regulation Authority.

Aviva Investors UK Fund Services Limited, registered in England No. 1973412. Entered on the Financial Services Register, No. 119310. Authorised and regulated by the Financial Conduct Authority.

Aviva Investors UK Funds Limited, registered in England No. 2503054. Entered on the Financial Services Register, No. 147088. Authorised and regulated by the Financial Conduct Authority.

Registered Office for all companies: St Helen's, 1 Undershaft, London EC3P 3DQ. VAT number: 105 4373 00.

Telephone calls to Aviva Investors may be recorded for training or monitoring purposes. We may monitor traffic data of both business and personal emails. By replying to this email, you consent to us monitoring the content of any emails you send to or receive from Aviva Investors.