

EXISTING & PROPOSED ROOF PLANS AND SITE LAYOUT (1:100)

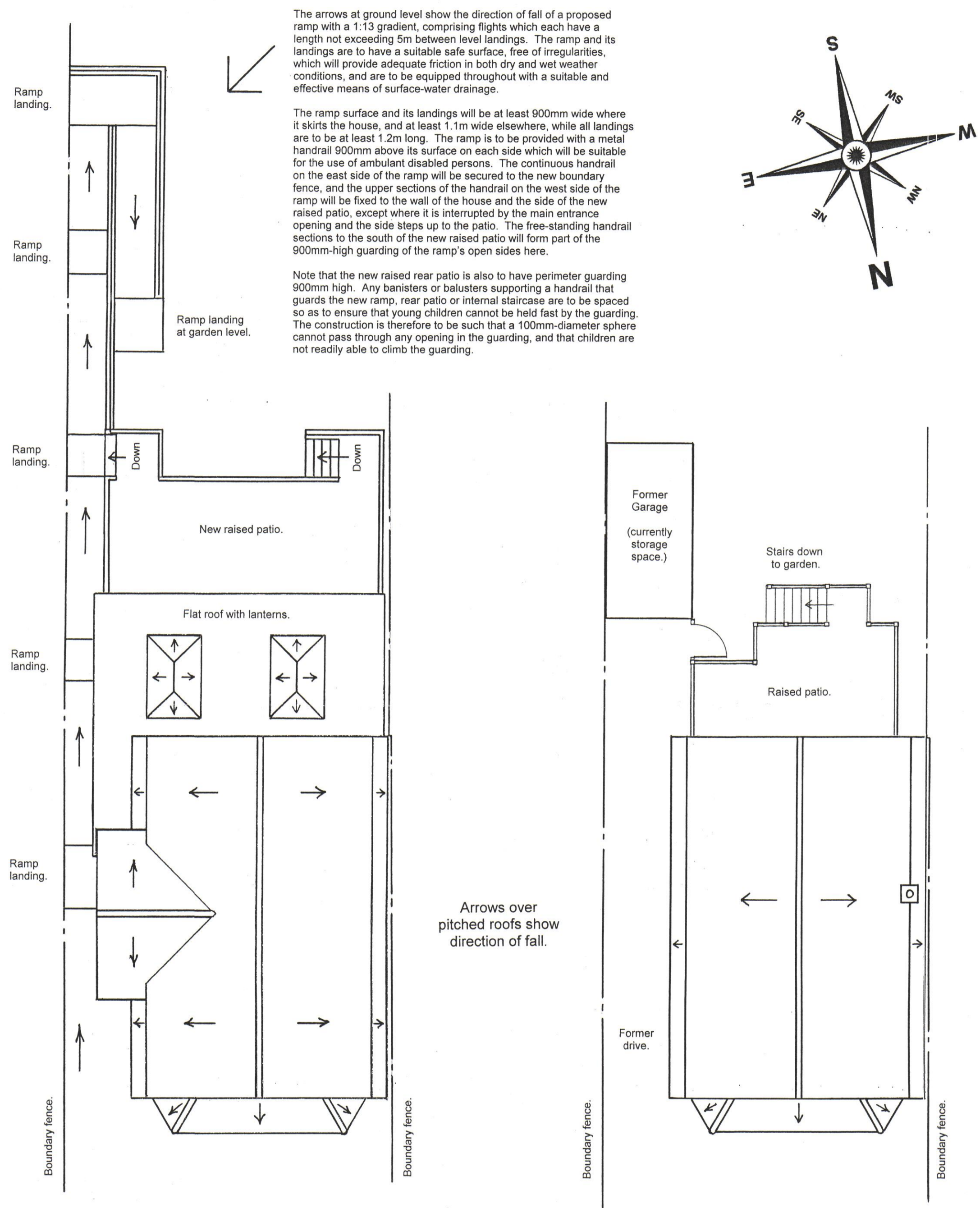

PROPOSED ROOF PLAN, REAR PATIO AND SIDE RAMP LAYOUT.

EXISTING ROOF PLAN, REAR PATIO AND OUTBUILDING LAYOUT.

1:10-scale cross-section of new "warm-deck" rear extension roof.

The cross-section shown is that between one of the two roof-lanterns and the rear external wall.

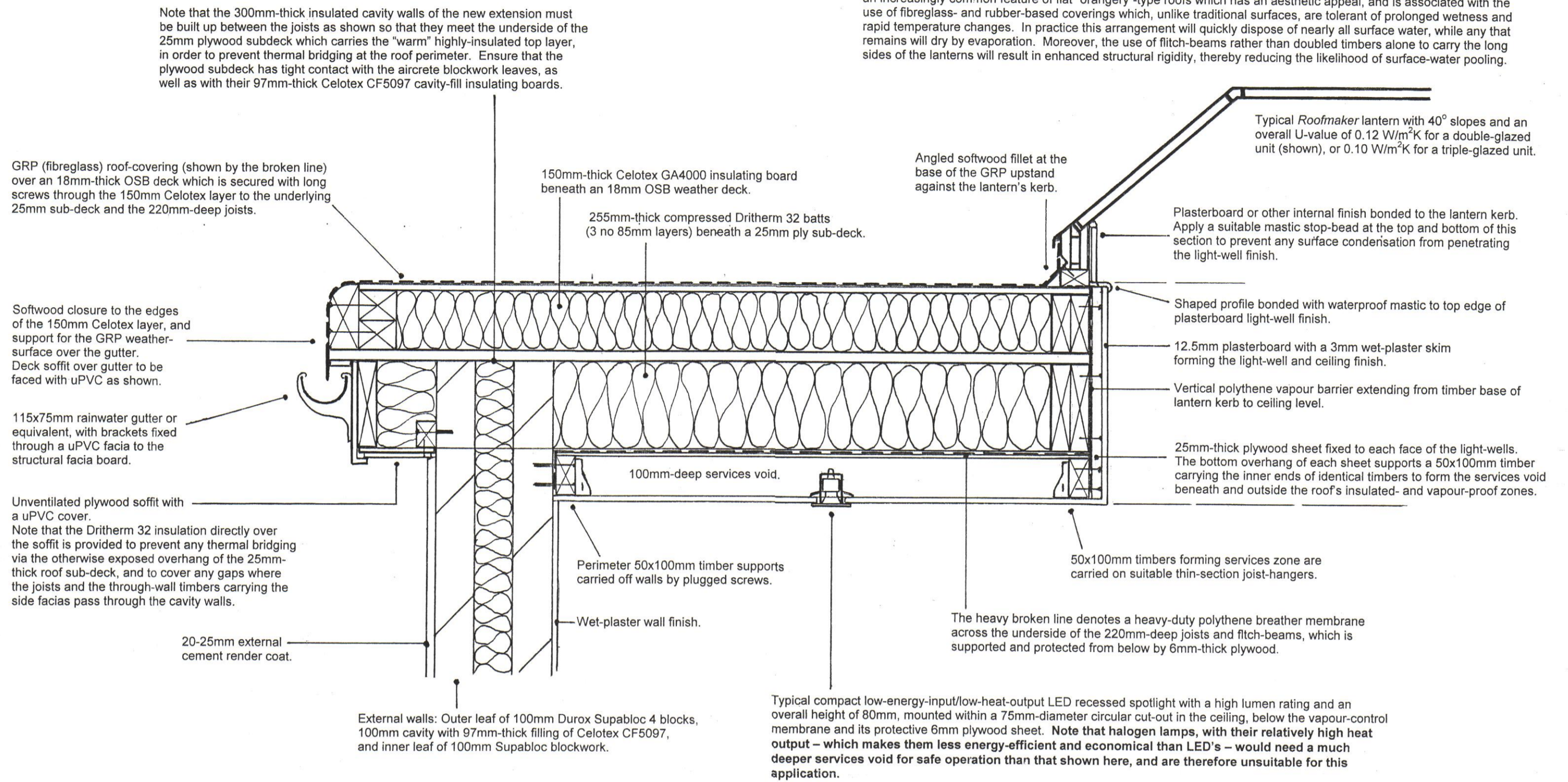

PLANNING - & BUILDING REGULATIONS APPLICATION Sheet 4 of 6

CLIENTS AND SITE LOCATION:
MR AND MRS PEILE,
278, EASTWOOD ROAD, RAYLEIGH, ESSEX, SS6 7LS.

PROPOSALS:
Construct a two-storey side extension, in conjunction with a single-storey flat-roofed side- and rear extension with roof-lanterns, and a new raised patio and external staircase down to the garden at the rear of the dwelling.

AGENT:
BARRY SKINNER,
16, FOUNTAIN LANE, HOCKLEY, ESSEX, SS5 4SU.
Telephone: 01702 – 203750 and 07932 – 741948.
e-mail: barryskinner@btinternet.com

DRAWING NUMBER 17/0109 : 4(6). JANUARY 2017

SHEET 4 OF 6: ANNOTATED CROSS-SECTION OF NEW WARM-DECK ROOF; EXISTING & PROPOSED ROOF PLANS & SITE LAYOUT.

24 JAN 2017
SUPPORT SERVICES