

**Agreement No:** ES2743AT

**Product Location:** Kitchen Window

**Customer Name:** Mr C Marshman

**Customer Address:** 151 High Street, Great Wakering, SOUTHEND-ON-SEA, Essex, SS3 0EB

*All designs are as viewed from inside and are not to scale*

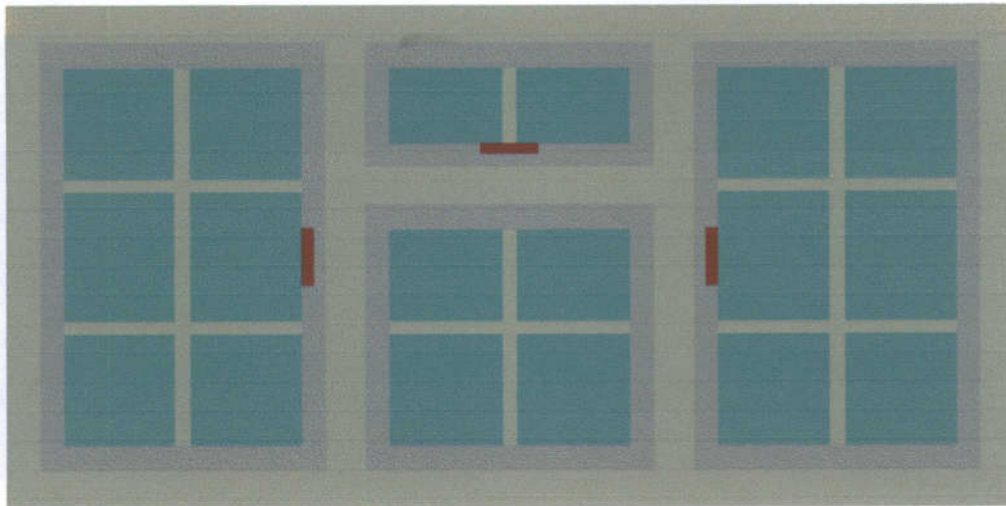

**Glass Sizes (mm)\***

Panel	Width	Height
A1	448	695
B1	449	162
B2	449	411
C1	448	695

\* Dimensions given relate to the total surface area of the sealed unit and not the visible glass area when installed in a frame

**Product Details**

Authentic Georgian	
Pane Width	251
Pane Height	250



I Agree to the Leaded Light/Georgian / Window/Door design as illustrated

Customer's Signature:

A handwritten signature in blue ink, appearing to be "C Marshman".

Date: 14/09/2015

**Agreement No:** ES2743AT

**Product Location:** Bathroom Window

**Customer Name:** Mr C Marshman

**Customer Address:** 151 High Street, Great Wakering, SOUTHEND-ON-SEA, Essex, SS3 0EB

*All designs are as viewed from inside and are not to scale*

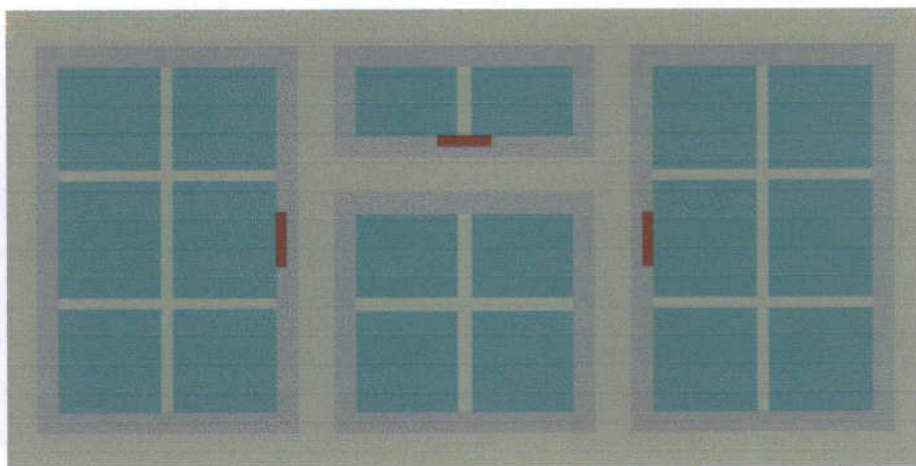

**Glass Sizes (mm)\***

Panel	Width	Height
A1	448	695
B1	449	162
B2	449	411
C1	448	695

\* Dimensions given relate to the total surface area of the sealed unit and not the visible glass area when installed in a frame

**Product Details**

Authentic Georgian  
Pane Width 251  
Pane Height 250



I Agree to the Leaded Light/Georgian / Window/Door design as illustrated

Customer's Signature:

Date: 14/09/2015

**Agreement No:** ES2743AT

**Product Location:** Rear Door

**Customer Name:** Mr C Marshman

**Customer Address:** 151 High Street, Great Wakering, SOUTHEND-ON-SEA, Essex, SS3 0EB

*All designs are as viewed from inside and are not to scale*

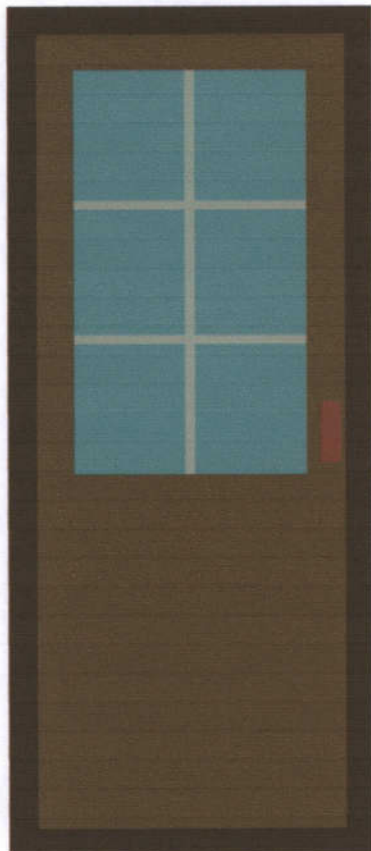

**Glass Sizes (mm)\***

Panel	Width	Height
A1	593	1013

\* Dimensions given relate to the total surface area of the sealed unit and not the visible glass area when installed in a frame

**Product Details**

Authentic Georgian	
Pane Width	282
Pane Height	328

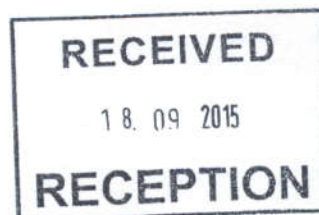

I Agree to the Leaded Light/Georgian / Window/Door design as illustrated

Customer's Signature:



Date: 14/09/2015

**Agreement No:** ES2743AT

**Product Location:** Kitchen 2 Window

**Customer Name:** Mr C Marshman

**Customer Address:** 151 High Street, Great Wakering, SOUTHEND-ON-SEA, Essex, SS3 0EB

*All designs are as viewed from inside and are not to scale*

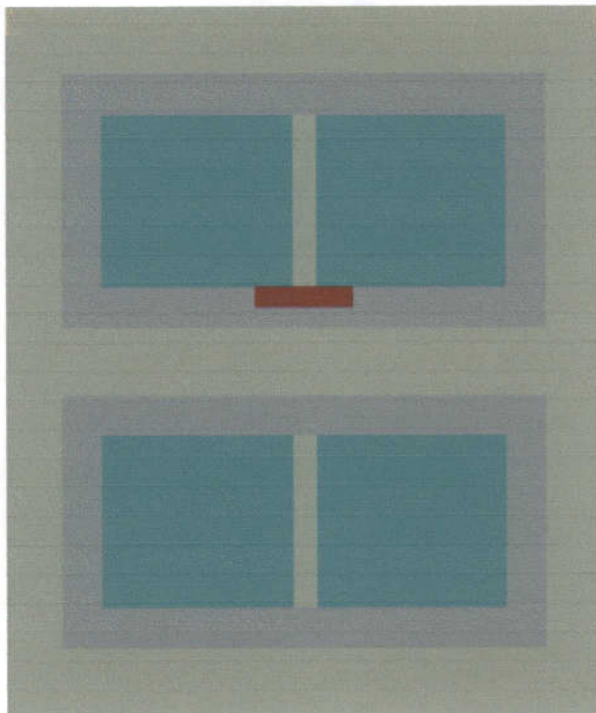

**Glass Sizes (mm)\***

Panel	Width	Height
A1	439	207
A2	439	206

\* Dimensions given relate to the total surface area of the sealed unit and not the visible glass area when installed in a frame

**Product Details**

Authentic Georgian	
Pane Width	247
Pane Height	295



I Agree to the Leaded Light/Georgian / Window/Door design as illustrated

Customer's Signature:

Date: 14/09/2015



**Agreement No:** ES2743AT

**Product Location:** Bedroom Window

**Customer Name:** Mr C Marshman

**Customer Address:** 151 High Street, Great Wakering, SOUTHEND-ON-SEA, Essex, SS3 0EB

*All designs are as viewed from inside and are not to scale*

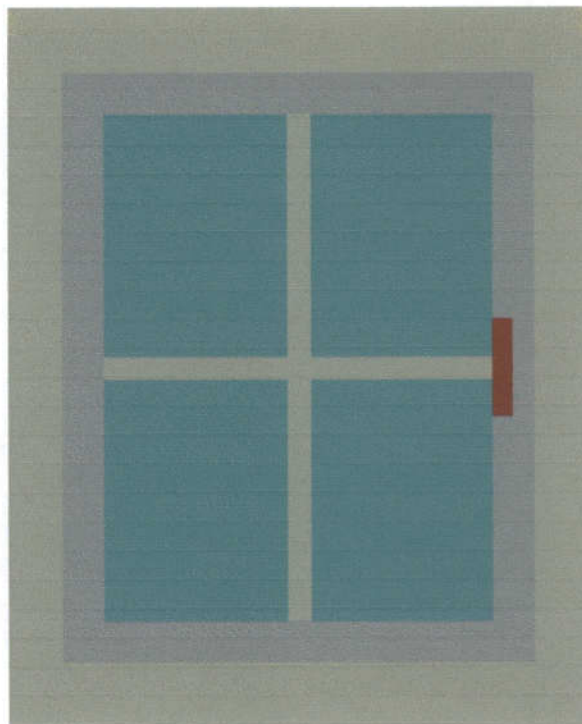

**Glass Sizes (mm)\***

Panel	Width	Height
A1	429	555

\* Dimensions given relate to the total surface area of the sealed unit and not the visible glass area when installed in a frame

**Product Details**

Authentic Georgian	
Pane Width	242
Pane Height	305



I Agree to the Leaded Light/Georgian / Window/Door design as illustrated

Customer's Signature:



Date: 14/09/2015



Return to  
Front Page

scale 1:2



Return to main  
elevation page

**OPTIONS**

Opening out flush

Opening in flush

## 92mm STORMPROOF

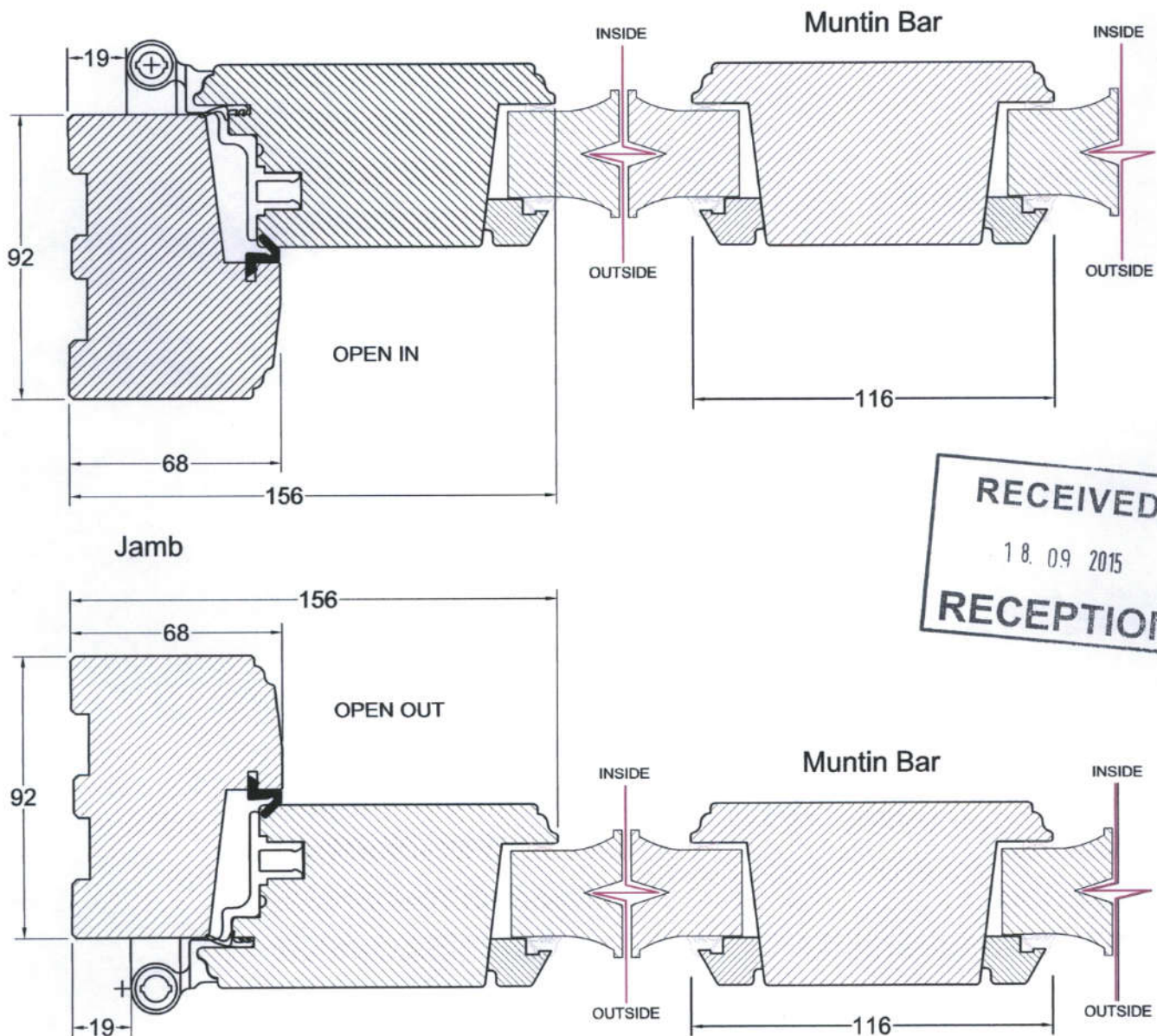





Return to  
Front Page

scale 1:2

### OPTIONS

Opening out flush casement

Opening in storm casement

Opening in flush casement



Return to main  
elevation page

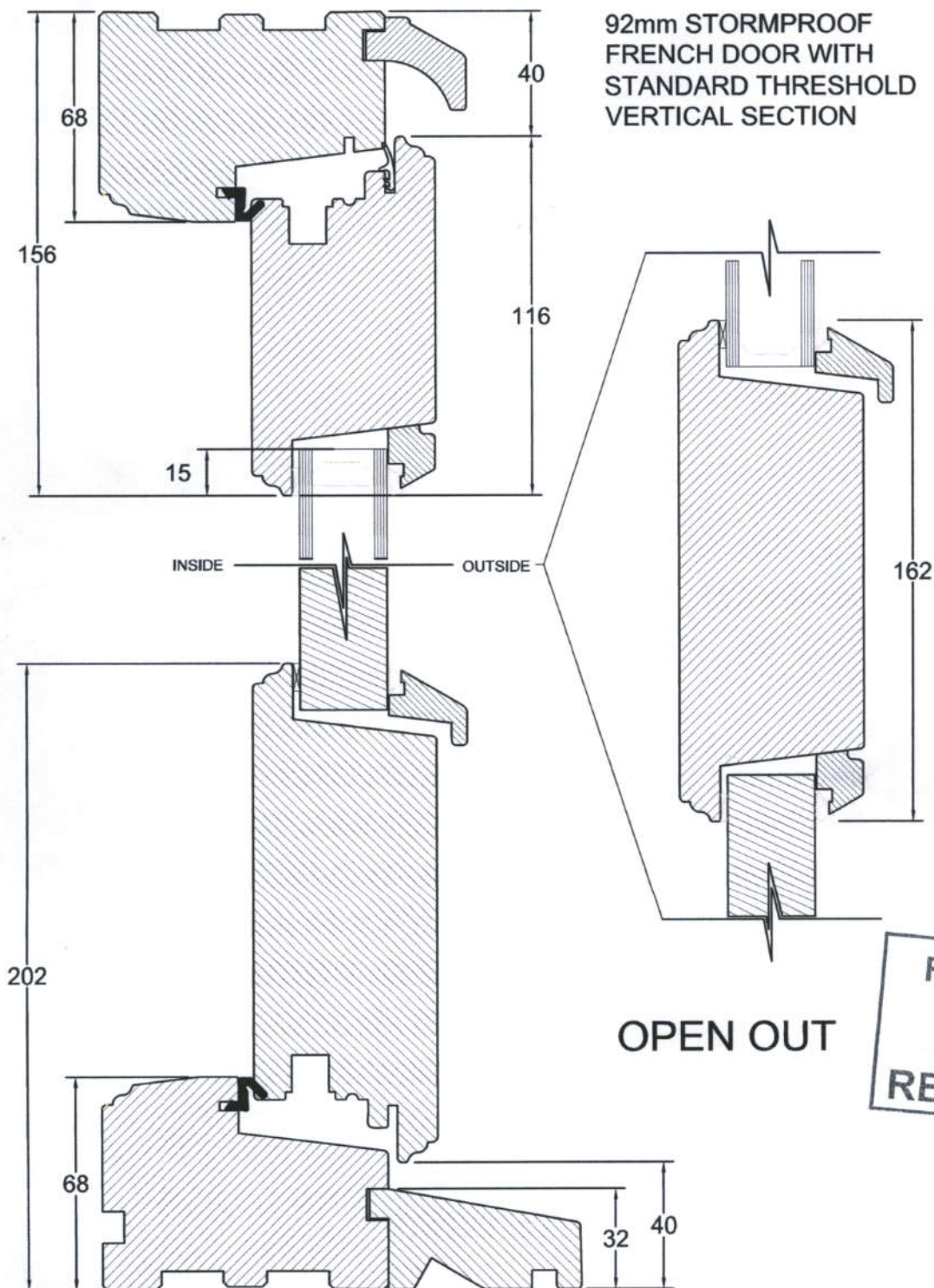

92mm STORMPROOF CASEMENT  
WINDOW  
VERTICAL SECTION

scale 1:2

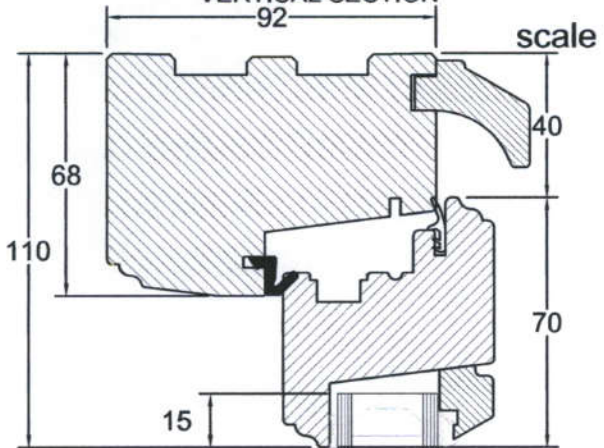

INSIDE OUTSIDE

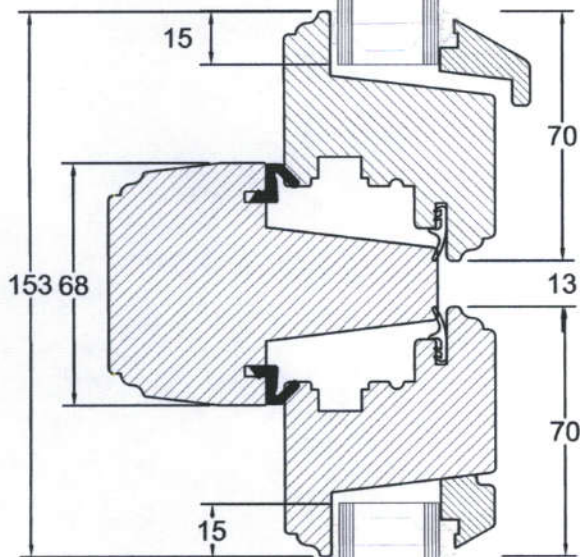

INSIDE OUTSIDE

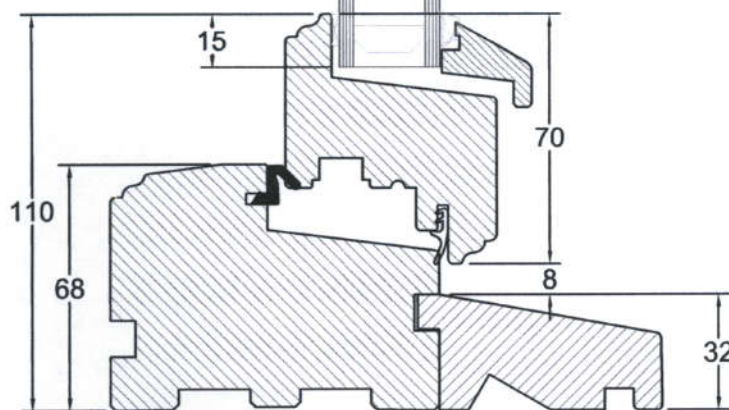

March 2015

Everest Limited

68mm STORMPROOF CASEMENT  
WINDOW  
VERTICAL SECTION

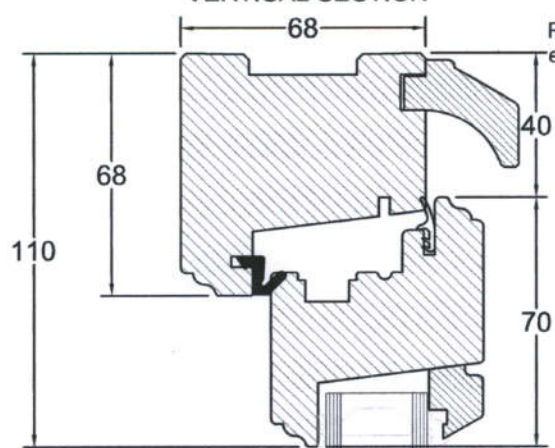

INSIDE OUTSIDE

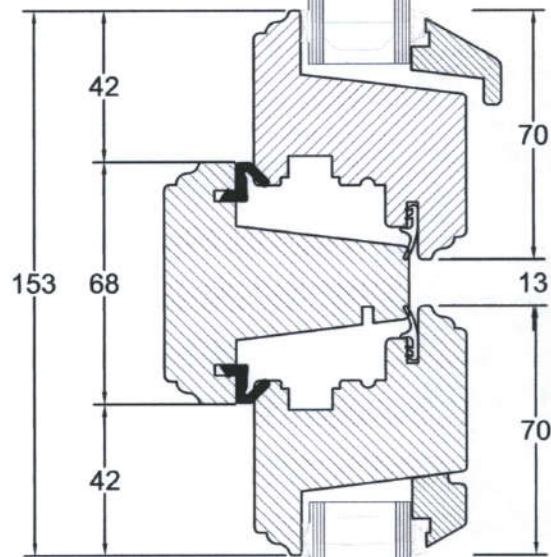

INSIDE OUTSIDE

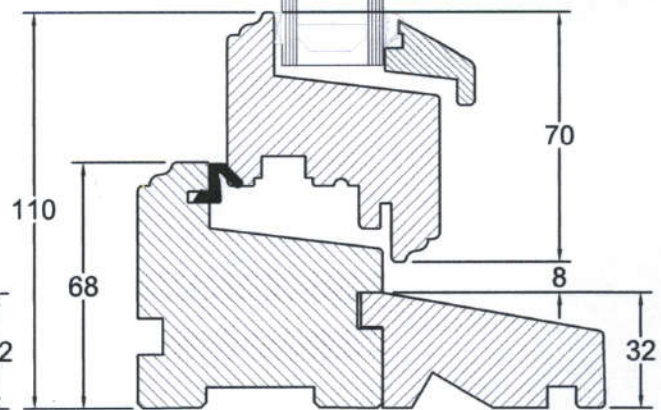

Page 8

Return to main  
elevation page

RECEIVED  
18.09.2015



68mm STORMPROOF CASEMENT  
WINDOW  
HORIZONTAL SECTION

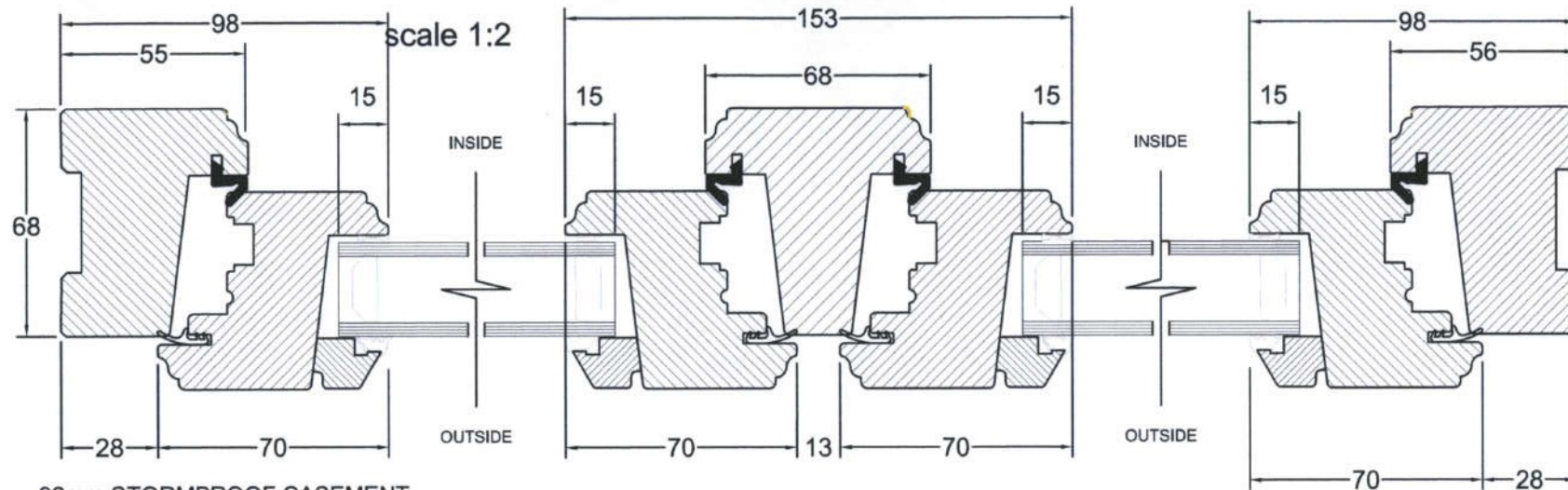

Return to main  
elevation page

92mm STORMPROOF CASEMENT  
WINDOW  
HORIZONTAL SECTION

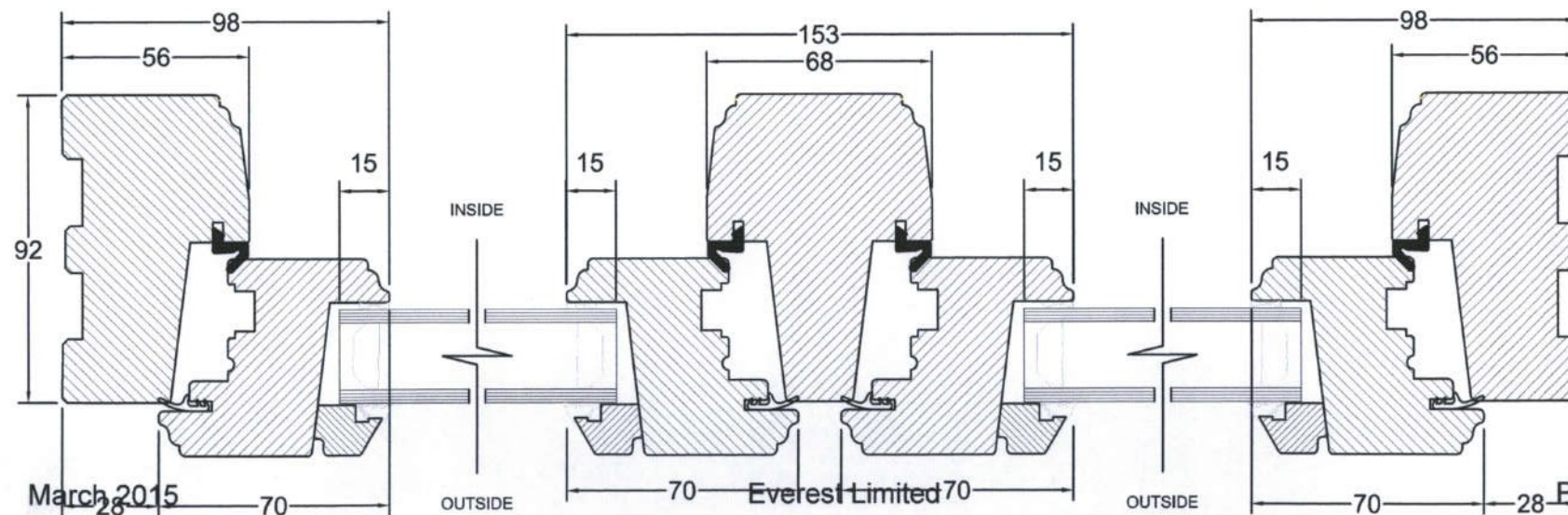

RECEIVED  
18.09.2015  
RECEPTION

March 2015

Everest Limited

Page 10