

Matthews Serjeant Architects
23 Bellingham Lane
Rayleigh
Essex SS6 7ED

County Hall
Market Road
Chelmsford
CM1 1QH

Our Ref: 2270174
Your Ref:
EH01/02a/2094
Date: 12 November
2013

Dear Sirs

KNIVET CLOSE, RAYLEIGH

I refer to your letter dated 17th October.

I attach a copy of a plan showing coloured yellow what is considered to be the extent of publicly maintainable highway within the area requested.

I hope this assists you and I attach a receipt for £40.

Yours faithfully

Graham Stannard
Highway Records
Essex Highways

Please reply to:
Tel: 01245 342566
Email: highwayrecords@essexhighways.org

Victoria Hatton
Organisation Support
Essex Highways
County Hall
Chelmsford
Essex
CM1 1QH

EH01/02a/2094
17 October 2013

Dear Sirs

Re: Clarification of Road Classification Kinvet Close Rayleigh

We refer you to our email dated 10th October and your subsequent reply dated 15th October 2013 regarding the above.

As explained we are looking at the possible development of land in the rear garden of 193 Eastwood Road which has a boundary on Knivet Close in Rayleigh between properties nos 36 & 45. The intention is to look at the possibility of building a pair of detached properties in this location.

We understand that the normal restriction on development off of a private drive is for a maximum of 5 dwellings. However, in a recent consultation with Mr Nick Barnes at Rochford Council regarding this site he has advised that Highways officers would accept 6 here. (see attached email) To be certain of the facts we need to ascertain the demarcation line and extent of the private drive and the adopted road according to your records. We attach a copy of the site OS plan from our client and it is our understanding that the area coloured red is the private drive whilst the rest of the close is adopted and constructed to highways standard. There appears to be a turning head not indicated on the OS plan in front of no 41 Kinvet Close.

We understand from your email that there is a search fee and enclose our cheque in the sum of £40.00 as requested. We look forward to receiving your clarification, comment please.

Yours faithfully,

John Serjeant
For and on behalf of
MATHEWS SERJEANT ARCHITECTS

RECEIVED

13.06.2014

Support Services

Location Plan

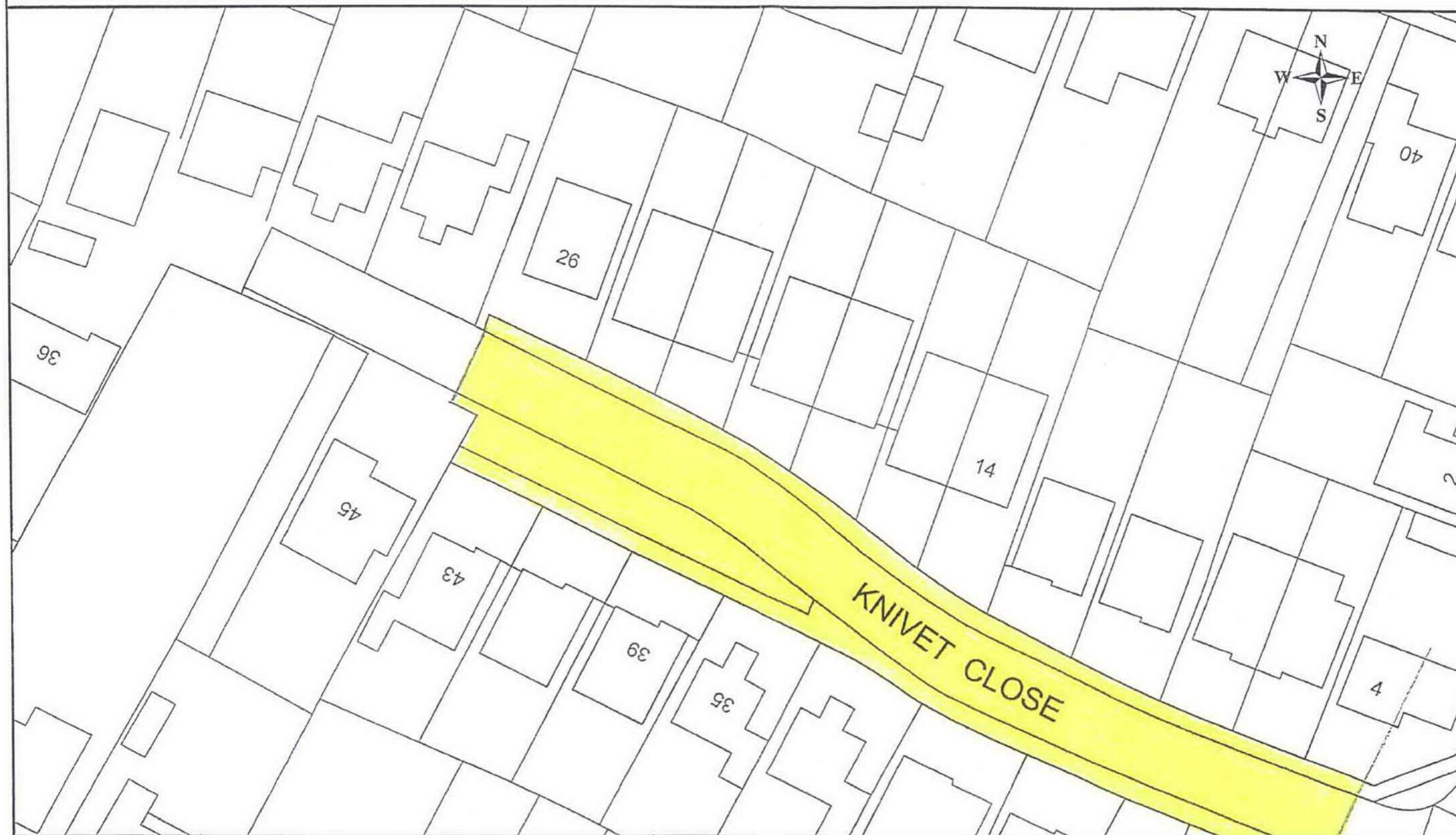

Essex
Highways

This information is given with the proviso that where there is a roadside ditch or pond, that ditch or pond and any land to the rear would not normally form part of the highway.

Drawn By
G Stannard

Scale
1:500

Date

? Crown copyright. All rights reserved 100019602
This Copy has been made by or with the authority of the Director of Environmental Services of Essex County Council, pursuant of Section 47 of the Copyright Designs and Patents Act 1988 (the Act) Unless the Act provides relevant exception to copyright the copy must not be copied without prior permission of the copyright owner.

www.essexhighways.org